

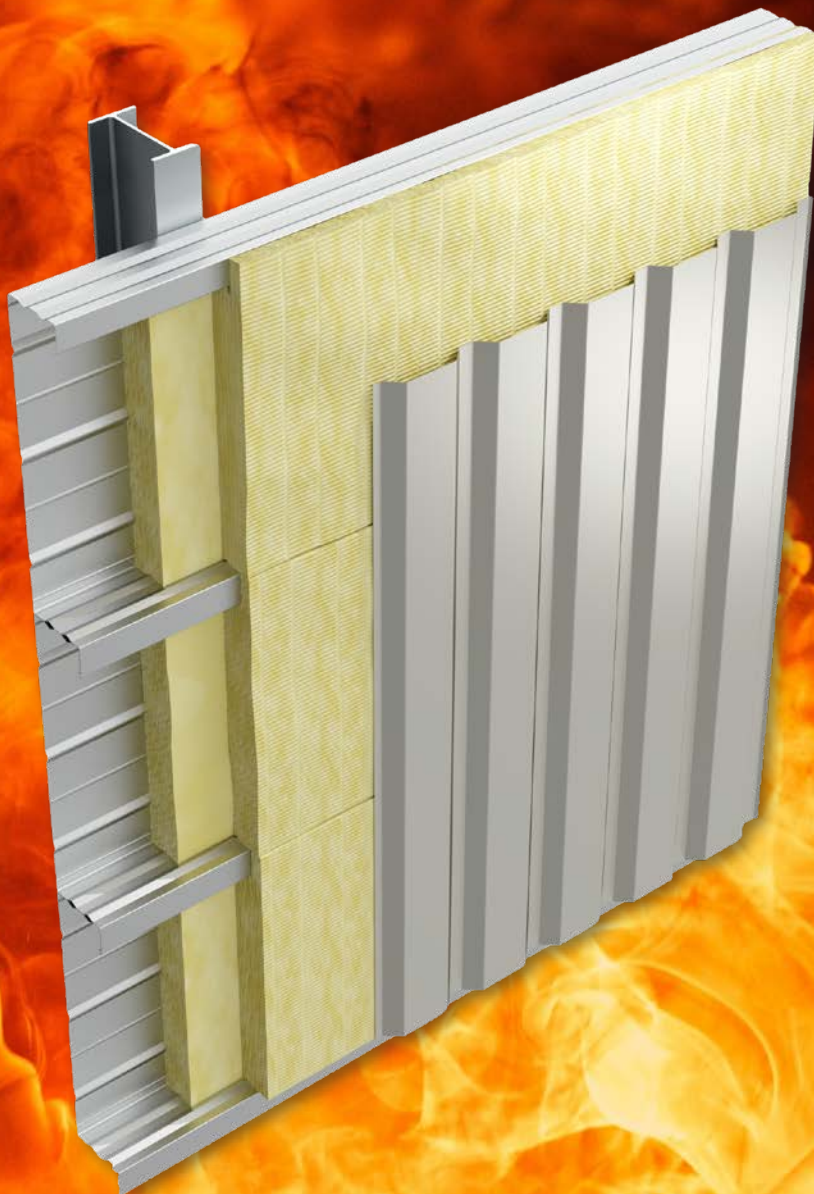

Solution for light folded facade

Globalwall®



transforming
tomorrow

Light folded facade Globalwall® with higher requirements for fire and acoustic solution

ArcelorMittal Construction **Globalwall®** light folded facade is another proof of our company's progressive approach to the introduction of innovative solutions. Based on our long-term experience in developing and manufacturing C tray profiles, facades, trapezoidal, sinusoidal and design profiles, we offer a solution that can interest all construction experts with its properties.

Globalwall® solutions will find its use in the production and storage halls, logistics and distribution centres, and many other projects run in public and industry sectors.

In terms of heat technology, fire safety and acoustics, the buildings must comply with a range of requirements arising from standards and effective regulations. Following such requirements, we recommend using the composition with mineral stone wool insulation.

Our offer of **Globalwall®** represents a perfect solution of light folded cladding with excellent technical parameters satisfying the most demanding requirements for fire resistance and acoustics.

In terms of light folded cladding, we offer a solution complying with demanding requirements for building quality and safety.

The exceptional technical parameters **have been proved by fire resistance tests, up to 120 minutes, and airborne sound insulation measurements, up to 55 dB**, which were confirmed by issued reports.

Outstanding technical parameters, quality of material, lifetime and technical counselling – that are the reasons why to prefer ArcelorMittal Construction **Globalwall®** products and solutions when choosing light folded facade.

We build on quality - so that you could build further on it.

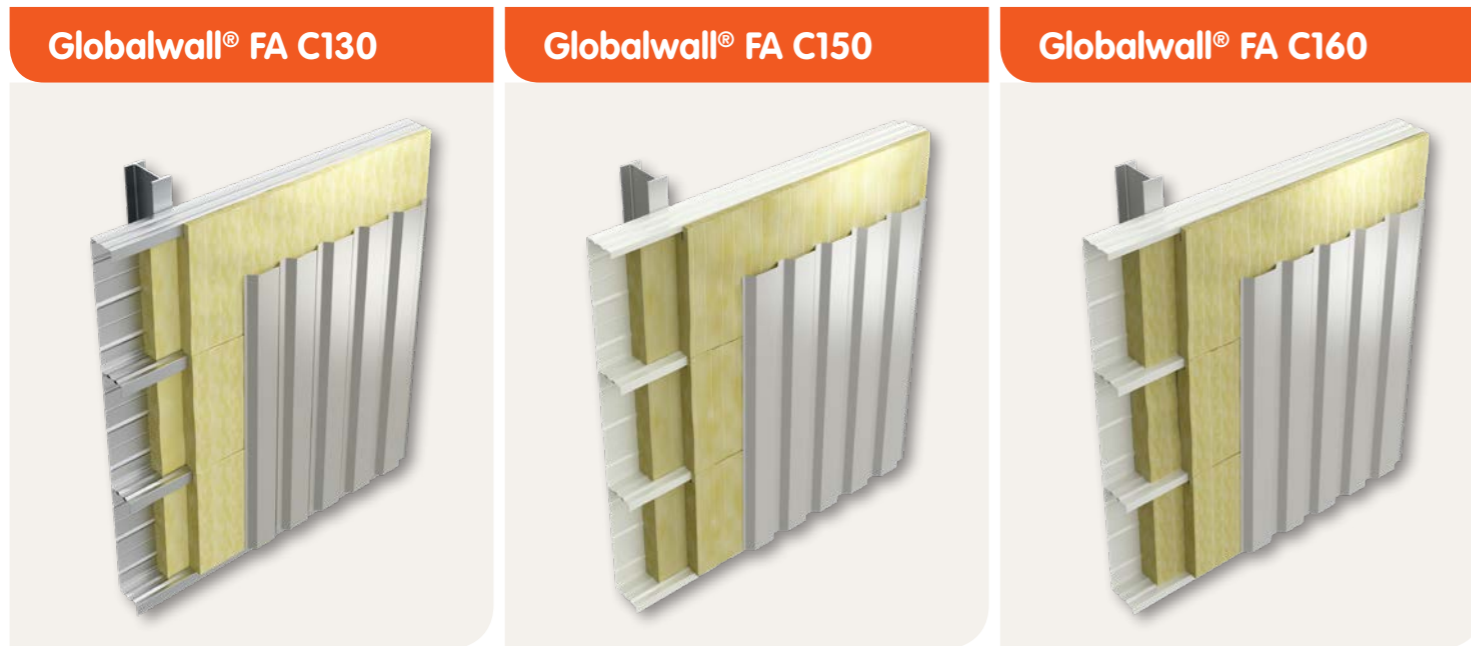

- | | | |
|---|--|--|
| <p>Typical structure of Globalwall® FA 130:</p> <ul style="list-style-type: none"> • AMC 130/600, thickness 0,75 mm • Mineral stone wool insulation 80+80 mm • Fasteners • AMC 32/207, thickness 0,63 mm | <p>Typical structure of Globalwall® FA 150:</p> <ul style="list-style-type: none"> • AMC 150/600, thickness 0,75 mm • Mineral stone wool insulation 100+80 mm • Fasteners • AMC 32/207, thickness 0,63 mm | <p>Typical structure of Globalwall® FA 160:</p> <ul style="list-style-type: none"> • AMC 160/600, thickness 0,75 mm • Mineral stone wool insulation 120+80 mm • Fasteners • AMC 32/207, thickness 0,63 mm |
|---|--|--|

- Benefits:**
- excellent fire resistance and airborne sound insulation
 - cost-effective solution for each building
 - minimizing thermal bridges
 - environmentally friendly and hygienic
 - long lifetime
 - easy to install

Make the most of our wide-ranging offer of facade profiles and choose from trapezoidal, sinusoidal or design profiles having different colours and coatings.

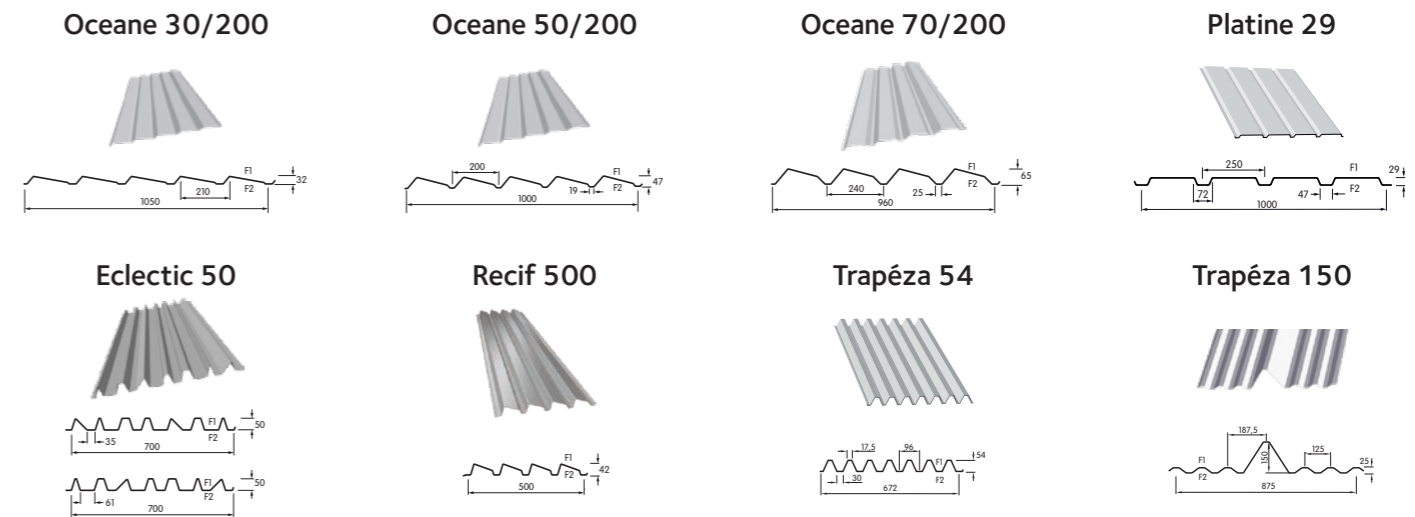

Name of solution	C tray		Mineral stone wool insulation Thickness (mm)		Spacer screw (mm)	Facade profile*		Wall thickness (mm)	U _D (W/m ² K)	Fire resistance (min)	R _w (dB)
	Type	Thk. (mm)	1 st board	2 nd board		Type	Thk. (mm)				
Globalwall® FA C130/40	AMC 130/600	0,75	80	80	40	AMC 32/207*	0,63	205	0,223	E (i→o) 120	47
Globalwall® FA C130/80			50	160	80			245			
Globalwall® FA C150/40	AMC 150/600	0,75	100	80	40	AMC 32/207*	0,63	225	0,199	EI (i→o) 45	50
Globalwall® FA C150/80			60	160	80			265			
Globalwall® FA C160/40	AMC 160/600	0,75	120	80	40	AMC 32/207*	0,63	235	0,179	EW (i→o) 120	51
Globalwall® FA C160/80			80	160	80			275			

Mineral stone wool with density ≥ 50 kg/m³, λ₀ = 0,035 W/m²K

(600x1200) (610x1200)

* possibly other trapezoidal, sinusoidal or design profiles according to fire classification report

¹⁾ C160/0,75 + 32/0,75
²⁾ C160/1,25 + 32/0,75



- Excellent fire resistance
- Exceptional airborne sound insulation
- Optimal thermal insulation
- Easy handling and assembly
- ECO friendly

For additional information, please, contact our technical/sales department.



ArcelorMittal

Sales:

ArcelorMittal Construction

www.amc-czech.com

www.amc-slovakia.com

www.amc-croatia.com

www.amc-hungary.com



This leaflet is not a contract document. The technical information contained inside is for explanation only. We are not responsible for the published content. If the content is inconsistent with the new official materials, the new materials are current

11/2018